

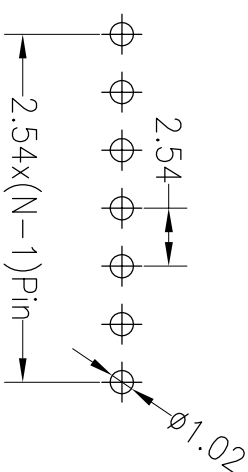

SPECIFICATIONS

Rated Current: 3.0AMP
 Contact Resistance: 20mΩ Max
 Withstand Voltage: 1000V AC/DC
 Insulation Resistance: 1000MΩ Min
 Operation Temperature: -40°C to +105°C
 Contact Material: Brass
 Contact Plating: Au or Sn Over Ni
 Insulator Material: Polyester (UL94V-0)
 Standard: PA6T
 Max. Processing Temp: 230°C for 30-60 seconds
 (260°C for 5 seconds)

Recommended P.C.B Layout (Top Side)
 (PCB BOARD TOLERANCE ±0.05)

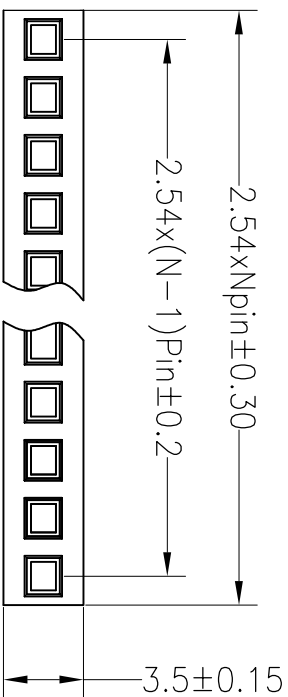

Ordering Information

2260 01 XX X N XX S O X 01

No. of Pins Per Row 1*40
 Insulator Material Option
 A=BK-PBT
 C=BK-PA6T
 D=BK-PA46
 E=BK-PA9T
 F=BK-LCP
 Contact Plating
 G1: Gold Flash
 G2: 1.5U" Gold
 G3: 2U" Gold
 G4: 3U" Gold
 G5: 5U" Gold
 S0: Gold Flash/Tin
 SN: Tin
 Packing
 0=PE Bag
 A=Tray
 T=Tube
 P=Tube+Cap
 R=Reel+Cap
 M=Reel+Mylar

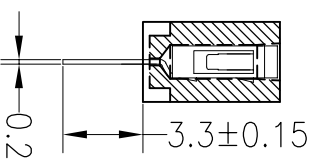
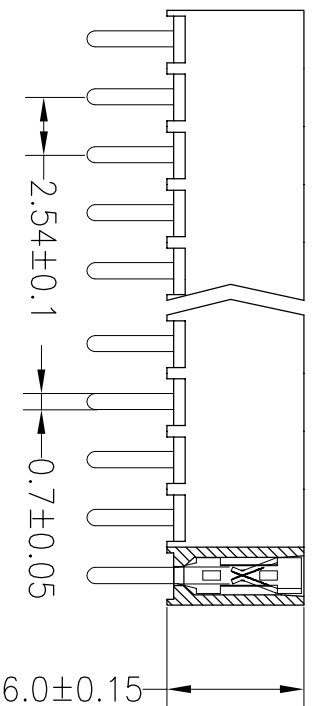

OPERATION		DRAW		SCALE		FIT		TITLE:	
X.X	±0.30		WZG	UNIT	mm	A4	1/1	PART NO. 226001XXXXXXSOX01	
X.XX	±0.20	CHECK		SIZE				2.54PF 1xNPin H6.0 W3.5 180°	
X:XXX	±0.10	APPROVE		SHEET	1/1				
Angle	±3°	PROV.		PROV.					
DIM	TOL	APPROVE							
DATE	MODIFICATION DESCRIPTION	CHANGE							
2012.03.28	NEW DRAWING								
REV									
1									

JILIN 深圳市锦凌电子有限公司
 SHENZHEN JINLING ELECTRONIC CO.,LTD
 Tel: 86-755-2997-5806/5802 Fax: 86-755-2997-5892